

Soils Map

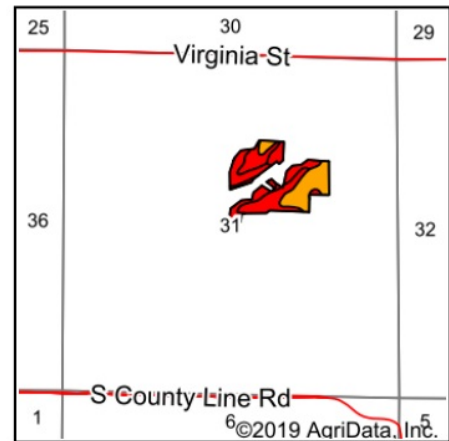

State: **Iowa**
 County: **Warren**
 Location: **31-74N-24W**
 Township: **Squaw**
 Acres: **25.37**
 Date: **3/26/2019**

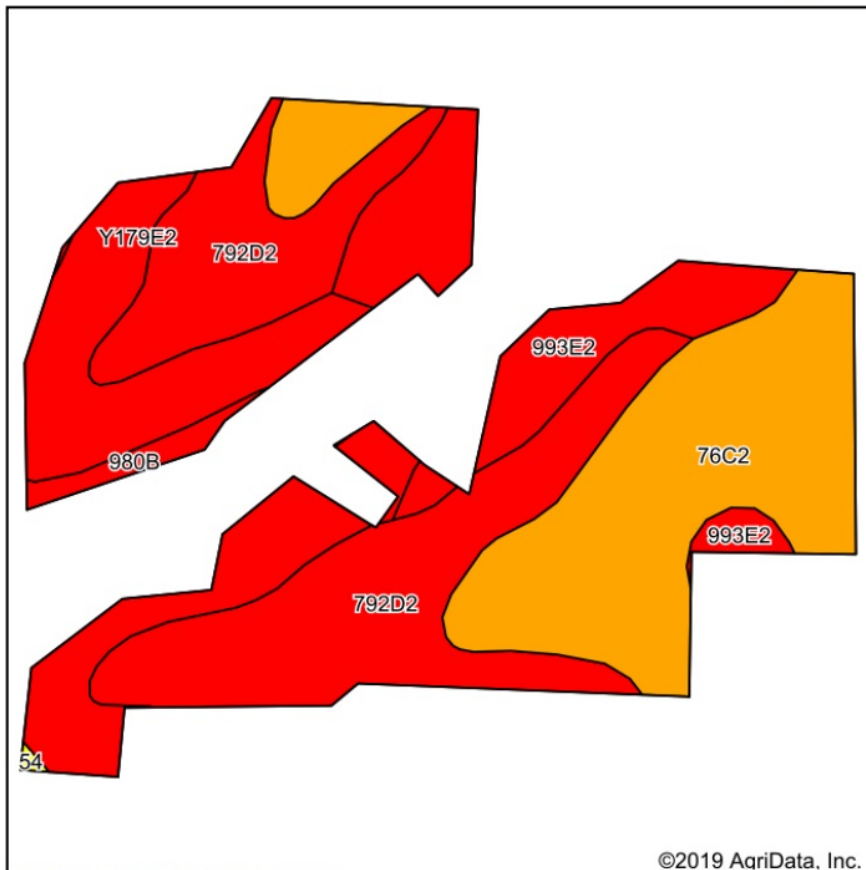

Maps Provided By:



Area Symbol: IA181, Soil Area Version: 23

Code	Soil Description	Acres	Percent of field	CSR2 Legend	Non-Irr Class *c	CSR2**	CSR	*n NCCPI Soybeans
792D2	Armstrong loam, 9 to 14 percent slopes, moderately eroded	8.30	32.7%		IVe	7	13	41
76C2	Ladoga silt loam, dissected till plain, 5 to 9 percent slopes, eroded	7.72	30.4%		IIIe	75	65	63
Y179E2	Gara loam, dissected till plain, 14 to 18 percent slopes, eroded	5.44	21.4%		VIe	32		48
993E2	Armstrong-Gara loams, 14 to 18 percent slopes, moderately eroded	3.49	13.8%		VIe	17	5	41
980B	Gullied land-Ely-Colo complex, 2 to 5 percent slopes	0.42	1.7%		VIIe	42	25	5
Weighted Average						35	*-	*n 48.6

**IA has updated the CSR values for each county to CSR2.

*- CSR weighted average cannot be calculated on the current soils data, use prior data version for csr values.

*n: The aggregation method is "Weighted Average using major components"

*c: Using Capabilities Class Dominant Condition Aggregation Method

Soils data provided by USDA and NRCS.