

# Soils Map

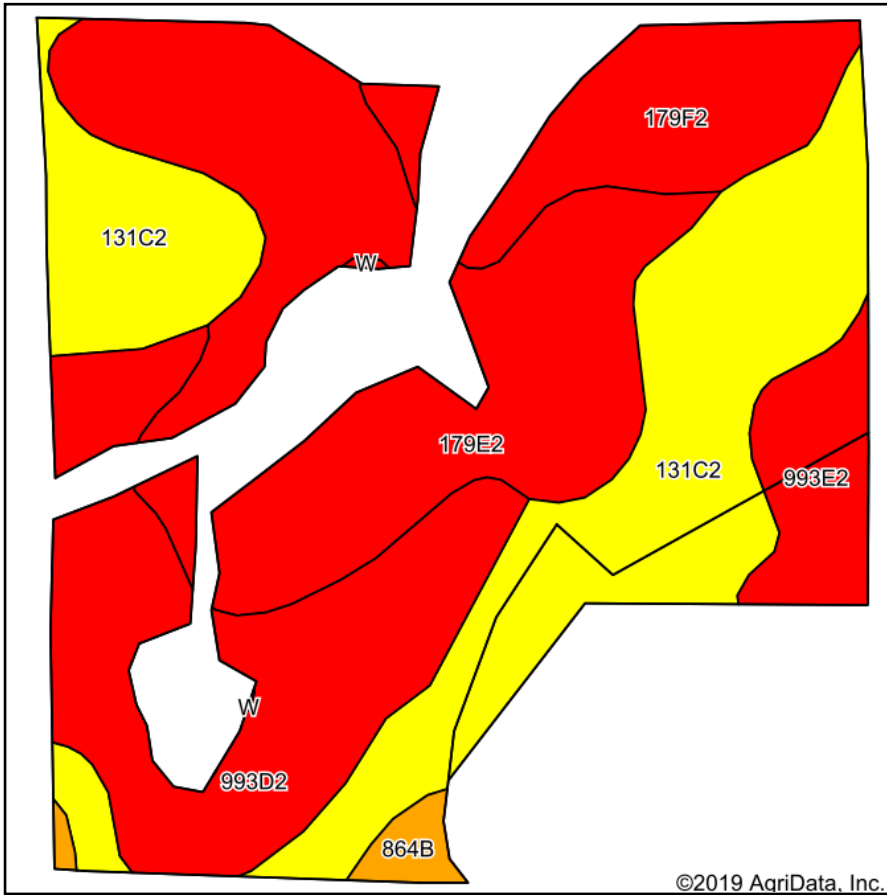

Soils data provided by USDA and NRCS.

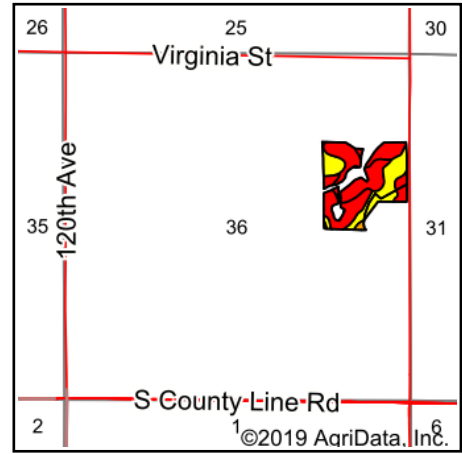

State: **Iowa**  
 County: **Warren**  
 Location: **36-74N-24W**  
 Township: **Squaw**  
 Acres: **28.88**  
 Date: **9/30/2019**



Maps Provided By:



Area Symbol: IA181, Soil Area Version: 23									
Code	Soil Description	Acres	Percent of field	CSR2 Legend	Non-Irr Class *c	CSR2**	CSR	*n NCCPI Soybeans	
131C2	Pershing silt loam, 5 to 9 percent slopes, moderately eroded	9.10	31.5%	Yellow	IIIe	62	50	49	
179E2	Gara loam, 14 to 18 percent slopes, moderately eroded	8.95	31.0%	Red	VIe	24	33	41	
993D2	Armstrong-Gara loams, 9 to 14 percent slopes, moderately eroded	5.96	20.6%	Red	IVe	23	20	46	
179F2	Gara loam, 18 to 24 percent slopes, moderately eroded	2.90	10.0%	Red	VIe	12	13	34	
993E2	Armstrong-Gara loams, 14 to 18 percent slopes, moderately eroded	1.56	5.4%	Red	VIe	17	5	41	
864B	Grundy silty clay loam, 2 to 5 percent slopes	0.41	1.4%	Orange	IIe	72	82	70	
<b>Weighted Average</b>						<b>34.9</b>	<b>32.8</b>	<b>*n 44.3</b>	

\*\*IA has updated the CSR values for each county to CSR2.

\*n: The aggregation method is "Weighted Average using major components"

\*c: Using Capabilities Class Dominant Condition Aggregation Method

Soils data provided by USDA and NRCS.