

Soils Map

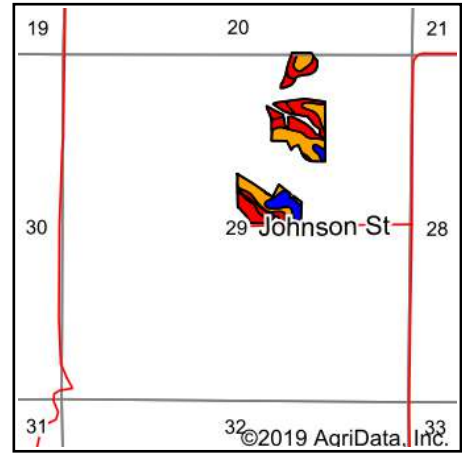

Soils data provided by USDA and NRCS.

©2019 AgriData, Inc.



State: **Iowa**
 County: **Warren**
 Location: **29-76N-22W**
 Township: **Union**
 Acres: **27.15**
 Date: **6/23/2019**



Maps Provided By:



Area Symbol: IA181, Soil Area Version: 23									
Code	Soil Description	Acres	Percent of field	CSR2 Legend	Non-Irr Class *c	CSR2**	CSR	*n NCCPI Soybeans	
76C2	Ladoga silt loam, dissected till plain, 5 to 9 percent slopes, eroded	11.13	41.0%	Yellow	IIIe	75	65	63	
993E2	Armstrong-Gara loams, 14 to 18 percent slopes, moderately eroded	9.15	33.7%	Red	VIe	17	5	41	
76B	Ladoga silt loam, 2 to 5 percent slopes	3.11	11.5%	Blue	Ile	86	85	78	
792D2	Armstrong loam, 9 to 14 percent slopes, moderately eroded	1.84	6.8%	Red	IVe	7	13	41	
65F	Lindley loam, 18 to 25 percent slopes	1.78	6.6%	Red	VIIe	14	10	42	
822D2	Lamoni silty clay loam, 9 to 14 percent slopes, eroded	0.14	0.5%	Red	IVe	10	15	40	
Weighted Average						47.8	39.7	*n 54.3	

**IA has updated the CSR values for each county to CSR2.

*n: The aggregation method is "Weighted Average using major components"

*c: Using Capabilities Class Dominant Condition Aggregation Method

Soils data provided by USDA and NRCS.