

Soils Map

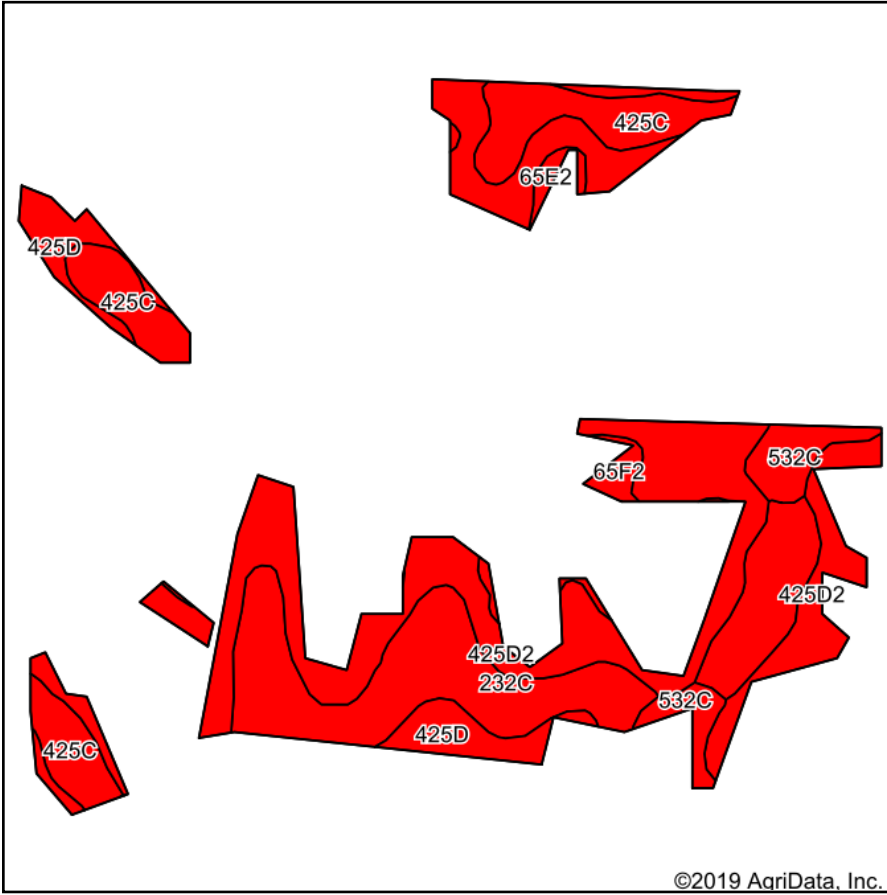

Soils data provided by USDA and NRCS.

©2019 AgriData, Inc.

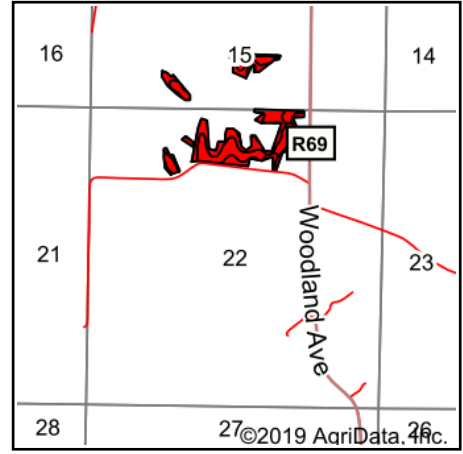

State: **Iowa**
 County: **Decatur**
 Location: **15-68N-24W**
 Township: **Woodland**
 Acres: **31.55**
 Date: **3/30/2020**



Maps Provided By:



© AgriData, Inc. 2019

www.AgriDataInc.com



Area Symbol: IA053. Soil Area Version: 25									
Code	Soil Description	Acres	Percent of field	CSR2 Legend	Non-Irr Class *c	CSR2**	CSR	*n NCCPI Soybeans	
425D2	Keswick clay loam, 9 to 14 percent slopes, moderately eroded	13.35	42.3%		IVe	8	12		35
232C	Keswick silt loam, 5 to 9 percent slopes	8.58	27.2%		IIIe	31	33		40
425C	Keswick loam, 5 to 9 percent slopes	4.80	15.2%		IIIe	36	28		39
425D	Keswick loam, 9 to 14 percent slopes	2.24	7.1%		IVe	8	16		44
532C	Rathbun silt loam, 5 to 9 percent slopes	1.67	5.3%		IIIe	47	32		61
65F2	Lindley clay loam, 18 to 25 percent slopes, moderately eroded	0.59	1.9%		VIIe	11	8		35
65E2	Lindley clay loam, 14 to 18 percent slopes, moderately eroded	0.32	1.0%		VIe	20	28		47
Weighted Average						20.8	21.6		*n 39.1

**IA has updated the CSR values for each county to CSR2.

*n: The aggregation method is "Weighted Average using major components"

*c: Using Capabilities Class Dominant Condition Aggregation Method

Soils data provided by USDA and NRCS.