

Soils Map

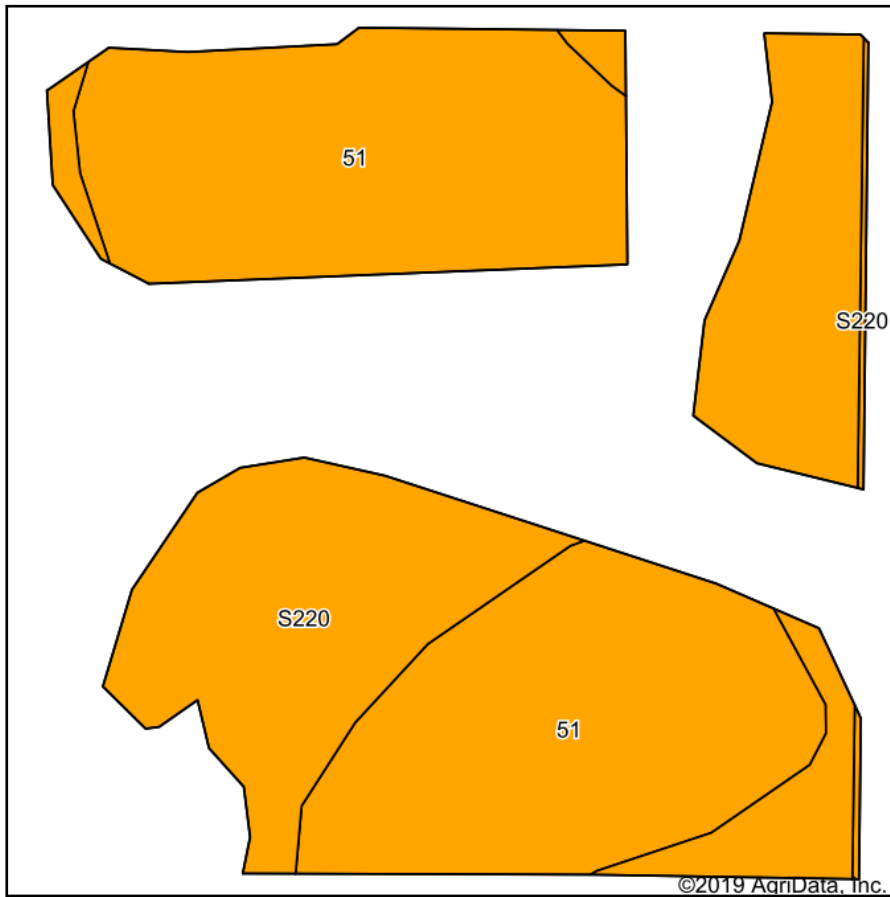

Soils data provided by USDA and NRCS.

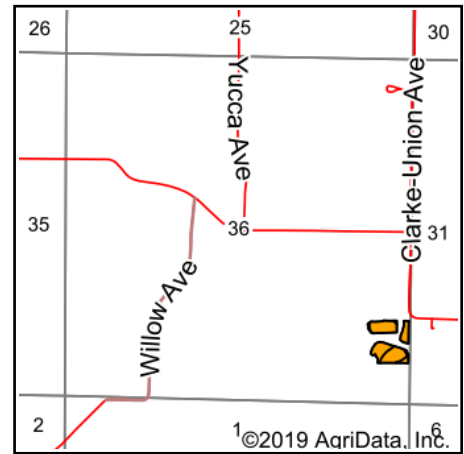

State: **Iowa**
 County: **Union**
 Location: **36-71N-28W**
 Township: **Pleasant**
 Acres: **5.62**
 Date: **6/10/2020**



Maps Provided By:



Area Symbol: IA039, Soil Area Version: 25								
Area Symbol: IA175, Soil Area Version: 22								
Code	Soil Description	Acres	Percent of field	CSR2 Legend	Non-Irr Class *c	CSR2**	CSR	*n NCCPI Soybeans
51	Vesser silt loam, 0 to 2 percent slopes, occasionally flooded	3.30	58.7%		llw	75	70	94
S220	Nodaway silt loam, heavy till, 0 to 2 percent slopes, occasionally flooded	2.32	41.3%		llw	77		80
Weighted Average						75.8	*-	*n 88.2

**IA has updated the CSR values for each county to CSR2.

*- CSR weighted average cannot be calculated on the current soils data, use prior data version for csr values.

*n: The aggregation method is "Weighted Average using major components"

*c: Using Capabilities Class Dominant Condition Aggregation Method

Soils data provided by USDA and NRCS.