

Soils Map

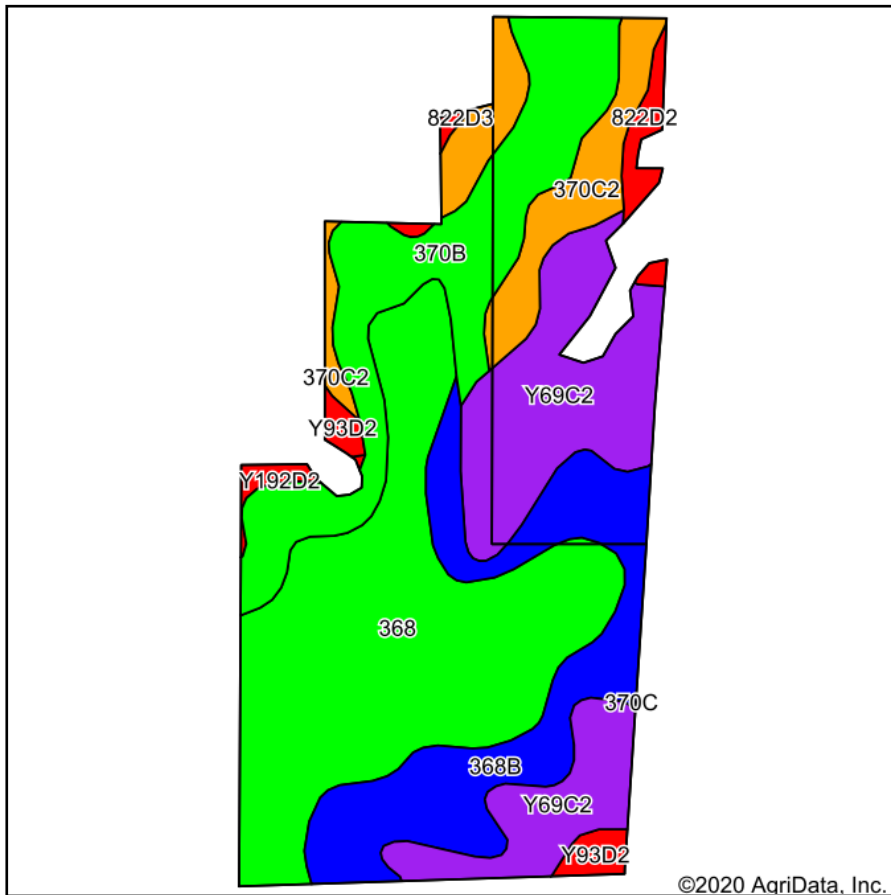

Soils data provided by USDA and NRCS.

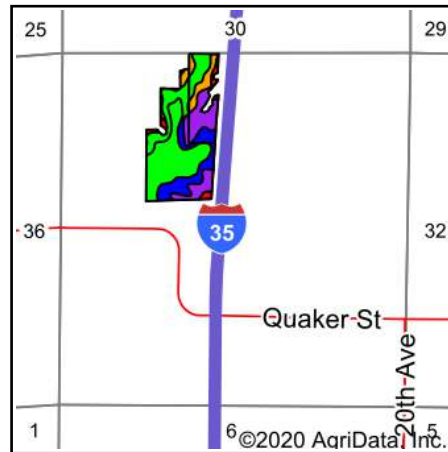

State: **Iowa**
 County: **Warren**
 Location: **31-75N-25W**
 Township: **Jackson**
 Acres: **42.87**
 Date: **10/28/2020**



Maps Provided By:



© AgriData, Inc. 2020

www.AgriDataInc.com



Area Symbol: IA181. Soil Area Version: 25										
Code	Soil Description	Acres	Percent of field	CSR2 Legend	Non-Irr Class *c	CSR2**	CSR	*n NCCPI Corn	*n NCCPI Soybeans	
368	Macksburg silty clay loam, 0 to 2 percent slopes	14.29	33.3%		Iw	93	95	87	79	
Y69C2	Clearfield silty clay loam, dissected till plain, 5 to 9 percent slopes, eroded	8.32	19.4%		IIIw	56		67	59	
370B	Sharpsburg silty clay loam, 2 to 5 percent slopes	7.56	17.6%		Ile	91	87	93	80	
368B	Macksburg silty clay loam, 2 to 5 percent slopes	7.13	16.6%		Ile	89	90	87	78	
370C2	Sharpsburg silty clay loam, 5 to 9 percent slopes, eroded	3.81	8.9%		IIIe	80	67	84	67	
Y93D2	Shelby-Adair clay loams, dissected till plain, 9 to 14 percent slopes, eroded	0.67	1.6%		IIIe	35		70	51	
822D2	Lamoni silty clay loam, 9 to 14 percent slopes, eroded	0.67	1.6%		IVe	10	15	61	43	
Y192D2	Adair clay loam, dissected till plain, 9 to 14 percent slopes, eroded	0.28	0.7%		IVe	16		66	47	
822D3	Lamoni soils, 9 to 14 percent slopes, severely eroded	0.14	0.3%		VIe	5	5	54	38	
Weighted Average						80.7	*-	*n 83	*n 72.7	

**IA has updated the CSR values for each county to CSR2.

*- CSR weighted average cannot be calculated on the current soils data, use prior data version for csr values.

*n: The aggregation method is "Weighted Average using all components"

*c: Using Capabilities Class Dominant Condition Aggregation Method

Soils data provided by USDA and NRCS.