

# Soils Map

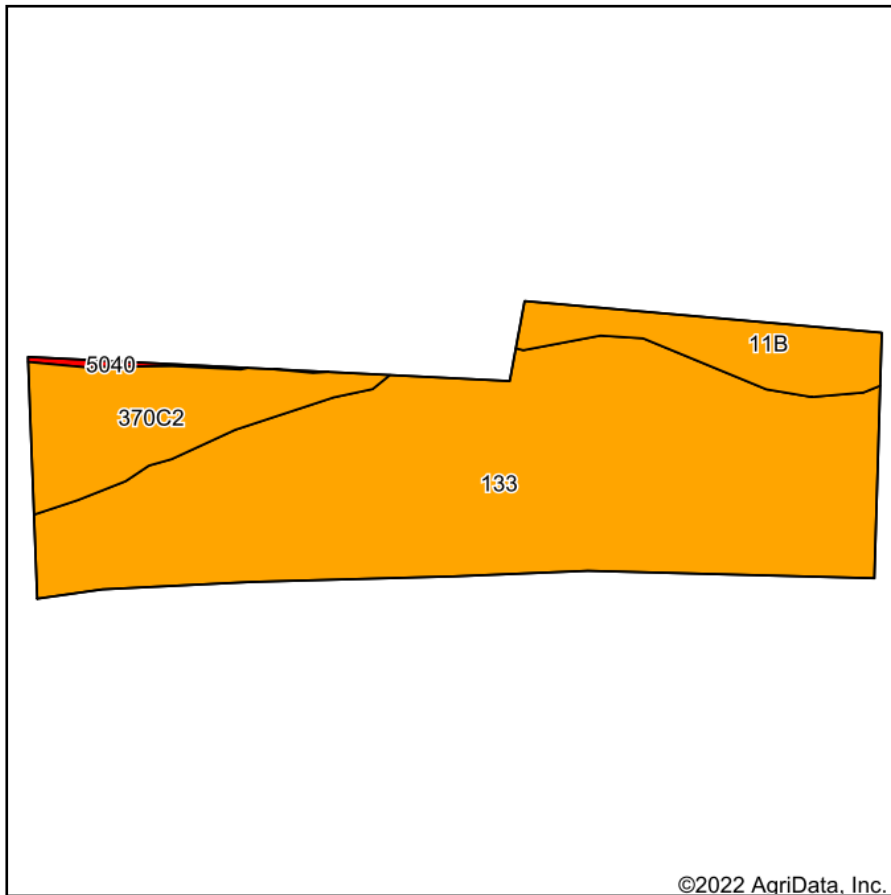

Soils data provided by USDA and NRCS.

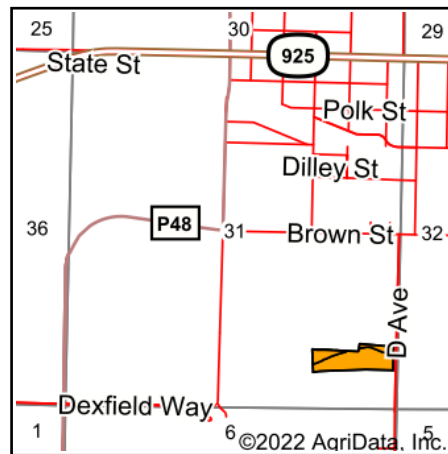

State: **Iowa**  
 County: **Dallas**  
 Location: **31-78N-29W**  
 Township: **Union**  
 Acres: **9.19**  
 Date: **12/9/2022**



Maps Provided By:



Area Symbol: IA049, Soil Area Version: 29

Code	Soil Description	Acres	Percent of field	CSR2 Legend	Non-Irr Class *c	*i Corn Bu	*i Alfalfa Tons	*i Soybeans Bu	CSR2**	*n NCCPI Corn	*n NCCPI Soybeans
133	Colo silty clay loam, deep loess, 0 to 2 percent slopes, occasionally flooded	7.09	77.1%		llw	204.8	4.3	59.4	78	75	59
370C2	Sharpsburg silty clay loam, 5 to 9 percent slopes, eroded	1.28	13.9%		llle	204.8	5.7	59.4	80	82	65
11B	Colo, occasionally flooded-Ely silty clay loams, dissected till plain, 2 to 5 percent slopes	0.82	8.9%		llw	204.8	4.3	59.4	80	86	81
<b>Weighted Average</b>						<b>2.14</b>	<b>204.8</b>	<b>4.5</b>	<b>78.5</b>	<b>*n 77</b>	<b>*n 61.8</b>

\*\*IA has updated the CSR values for each county to CSR2.

\*i Yield data provided by the ISPAID Database version 8.1.1 developed by IA State University.

\*n: The aggregation method is "Weighted Average using all components"

\*c: Using Capabilities Class Dominant Condition Aggregation Method

Soils data provided by USDA and NRCS.