

# Soils Map

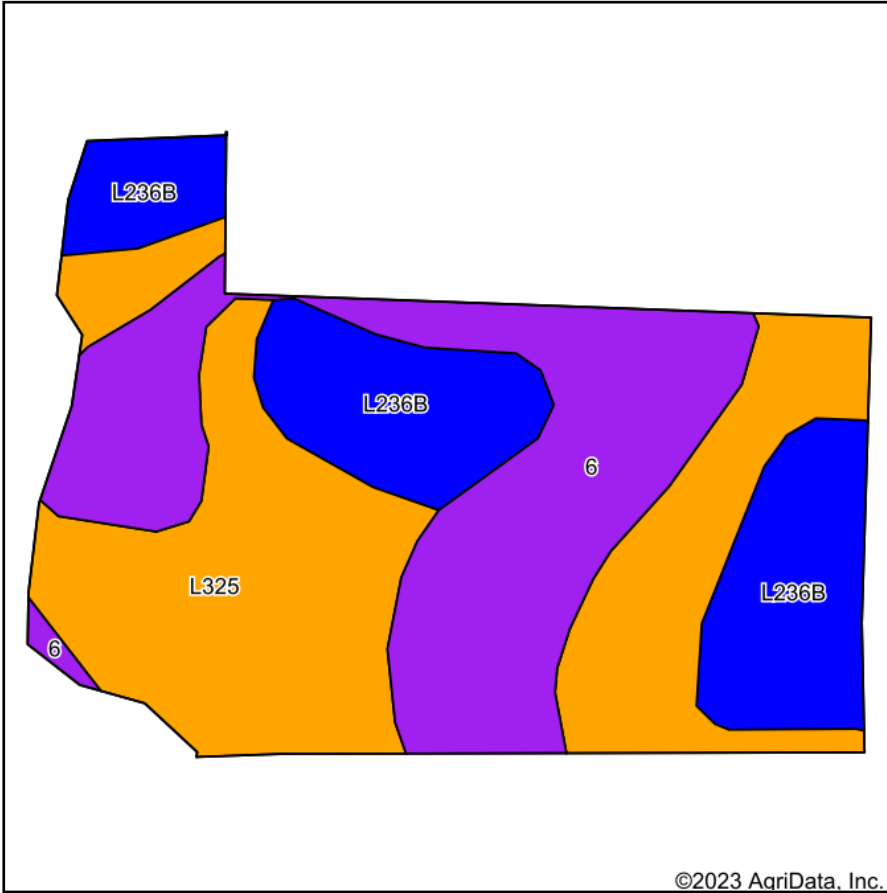

©2023 AgriData, Inc.

Soils data provided by USDA and NRCS.

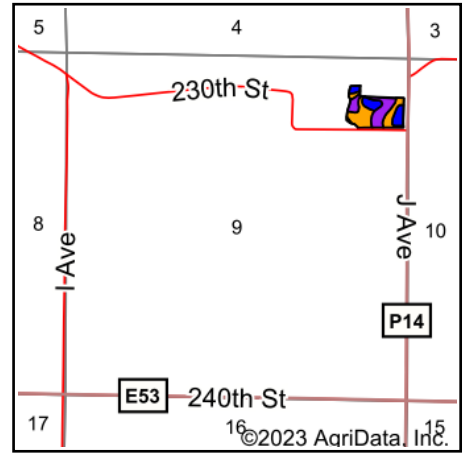

State: **Iowa**  
 County: **Greene**  
 Location: **9-83N-31W**  
 Township: **Jackson**  
 Acres: **9.56**  
 Date: **5/2/2023**



Maps Provided By:



© AgriData, Inc. 2023

www.AgriDataInc.com



Area Symbol: IA073, Soil Area Version: 28

Code	Soil Description	Acres	Percent of field	CSR2 Legend	Non-Irr Class *c	*i Corn Bu	*i Alfalfa Tons	*i Soybeans Bu	CSR2**	*n NCCPI Corn	*n NCCPI Soybeans
L325	Le Sueur loam, Bemis moraine, 1 to 3 percent slopes	4.06	42.5%		le	0.0	0.0	0.0	78	90	84
6	Okoboji silty clay loam, 0 to 1 percent slopes	3.10	32.4%		Illw	185.6	3.9	53.8	59	74	74
L236B	Lester loam, Bemis moraine, 2 to 6 percent slopes	2.40	25.1%		lle	0.0	0.0	0.0	85	87	77
<b>Weighted Average</b>						<b>1.90</b>	<b>60.2</b>	<b>1.3</b>	<b>73.6</b>	<b>*n 84.1</b>	<b>*n 79</b>

\*\*IA has updated the CSR values for each county to CSR2.

\*i Yield data provided by the ISPAID Database version 8.1.1 developed by IA State University.

\*n: The aggregation method is "Weighted Average using all components"

\*c: Using Capabilities Class Dominant Condition Aggregation Method

Soils data provided by USDA and NRCS.