

Soils Map

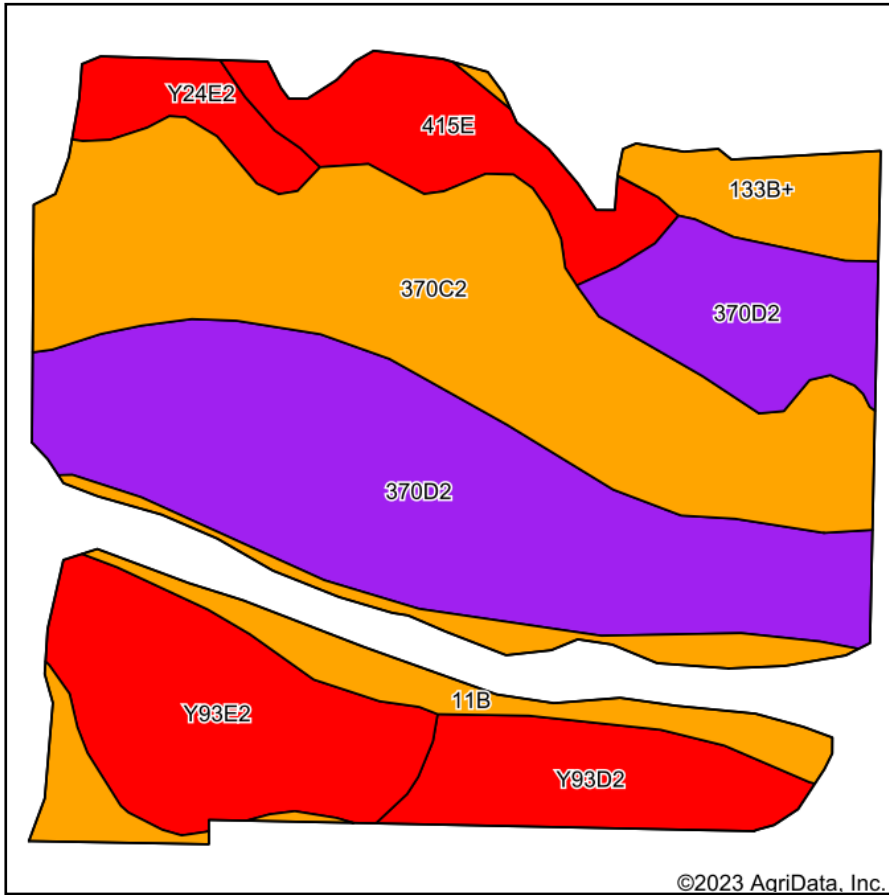

Soils data provided by USDA and NRCS.

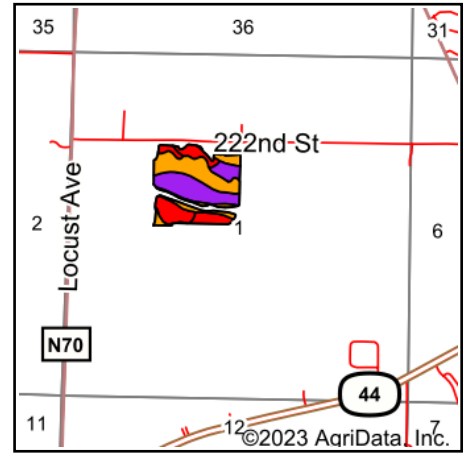

State: **Iowa**
 County: **Guthrie**
 Location: **1-79N-32W**
 Township: **Baker**
 Acres: **31.18**
 Date: **6/12/2023**



Maps Provided By:



Area Symbol: IA077, Soil Area Version: 31

Code	Soil Description	Acres	Percent of field	CSR2 Legend	Non-Irr Class *c	*i Corn Bu	*i Alfalfa Tons	*i Soybeans Bu	CSR2**	*n NCCPI Corn	*n NCCPI Soybeans
370D2	Sharpsburg silty clay loam, 9 to 14 percent slopes, eroded	10.28	33.0%		IIIe	177.6	5.0	51.5	54	77	60
370C2	Sharpsburg silty clay loam, 5 to 9 percent slopes, eroded	8.87	28.4%		IIIe	204.8	5.7	59.4	80	82	65
Y93E2	Shelby-Adair clay loams, dissected till plain, 14 to 18 percent slopes, eroded	3.66	11.7%		IVe	0.0	0.0	0.0	28	60	42
11B	Colo-Judson silty clay loams, 0 to 5 percent slopes, occasionally flooded	2.11	6.8%		IIw	216.0	4.5	62.6	80	85	81
Y93D2	Shelby-Adair clay loams, dissected till plain, 9 to 14 percent slopes, eroded	2.11	6.8%		IIIe	0.0	0.0	0.0	35	68	50
415E	Montieth loamy sand, 14 to 18 percent slopes	2.03	6.5%		VIe	80.0	2.2	23.2	5	12	15
133B+	Colo silt loam, dissected till plain, 2 to 5 percent slopes, overwash, occasionally flooded	1.22	3.9%		IIw	196.8	4.1	57.1	73	78	83
Y24E2	Shelby clay loam, dissected till plain, 14 to 18 percent slopes, eroded	0.90	2.9%		IVe	0.0	0.0	0.0	35	67	47
Weighted Average						3.30	144.3	3.9	55.8	*n 71.9	*n 57.6

**IA has updated the CSR values for each county to CSR2.

*i Yield data provided by the ISPAID Database version 8.1.1 developed by IA State University.

*n: The aggregation method is "Weighted Average using all components"

*c: Using Capabilities Class Dominant Condition Aggregation Method

Soils data provided by USDA and NRCS.